

Frontier Communications

Submit Date: 4/13/22

2611 45th ST

Work Order # 5295333

Dickinson, TX 77539

Office of Hopkins County Judge

The Honorable Robert Newsom

Frontier Communications is requesting permission to Bore 2781', install (1)2"x3" HH,
(6)17"x30" HH, (5)11"x11"x16" drop boxes, 22' of (2)-1.25" duct, and 2759' of (1)-1.25" duct at the
location of 200 Shiloh RD.

Site location map and construction drawings are enclosed. The construction sketch details all proposed work.

If you have any questions, please feel free to contact Darrin Albrecht @ 281-229-0849 or Darrin.albrecht@ftr.com

Submitted by:

Amy Younce

Permit coordinator

ayounce@chcconsulting.com

816-462-8312

Approved

Denied

Date: 4-18-22

County Comments: _____

Approval Signature: Wade Bentley

**FRONTIER COMMUNICATION
CONSTRUCTION SPECIFICATIONS**

- Contact Frontier Engineer CORY RIGGS at (310) 210-9882 sixty (60) days prior to need of service in order to confirm compliance, order materials, and schedule work forces. NOTE; FRONTIER COMMUNICATIONS, INCORPORATED, RESERVES THE RIGHT TO REFUSE ANY CONDUIT, PULL BOXES, MANHOLES, OR UTILITY BOXES THAT DEVIATE FROM PLANS AND SPECIFICATIONS.
- All conduit riser bends to have a minimum thirty-six (36) inch radius.
- All horizontal ninety (90) degree bends shall have a minimum radius of 12.5 feet and all vertical ninety (90) degree bends shall have a minimum radius of three feet. No more than two ninety (90) degree horizontal bends shall be placed in any single run unless otherwise specified. Contact the Frontier engineer concerning any required deviations.
- All conduit must be proven using a mandrel no less than a 1/2" smaller than the conduit placed. Wall to wall measurements must be taken with a measured tape and a 3/8" polypropylene pull rope in each duct. An accurate wall to wall measurement of conduit placed must be As-built on an approved Frontier construction plan. A copy of the As-built conduit work order must be provided to the Frontier inspector assigned to your project.
- Place weatherproof caps on all terminated conduits.
- Approved plastic conduit (PVC Sch. 40, TYPE-C or HDPE (2") is to be used in underground construction unless otherwise specified.
- Conduit terminated on a pole must be PVC Sch. 80. Location of riser on pole will be called out by engineering on the construction plan.
- Conduit placed in same trench with primary power conduit must be separated by a minimum of twelve (12) inches of well-packed sand or three inches of concrete, and have a minimum of thirty-six (36) inches of cover when placed behind curb face. All street crossings and conduits placed in the driven portion of the roadway must have a minimum of forty-eight (48) inches of cover to top of pipe. CONTACT THE FRONTIER INSPECTOR 48 HOURS BEFORE TRENCHING AND UPON COMPLETION OF YOUR SUBSTRUCTURES TO SCHEDULE THE FINAL INSPECTION.

**PERMITTING AGENCY:
HOPKINS COUNTY**

PICK UP POINT:
COUNTY LIMIT

PATH FOOTAGE:
BORE = 2,781'

MATERIALS:
(1) NEW 2"x3" HH
(6) NEW 17"x30" HH
(5) NEW 11"x11"x16" DROP BOX
22' OF (2)-1.25" DUCTS
2759' OF (1)-1.25" DUCT



**Know what's below.
Call before you dig.**

CONDUIT DESIGN

**200 SHILOH RD
SHILOH RD & E LOOP 301
SULPHUR SPRINGS, TX 75482**

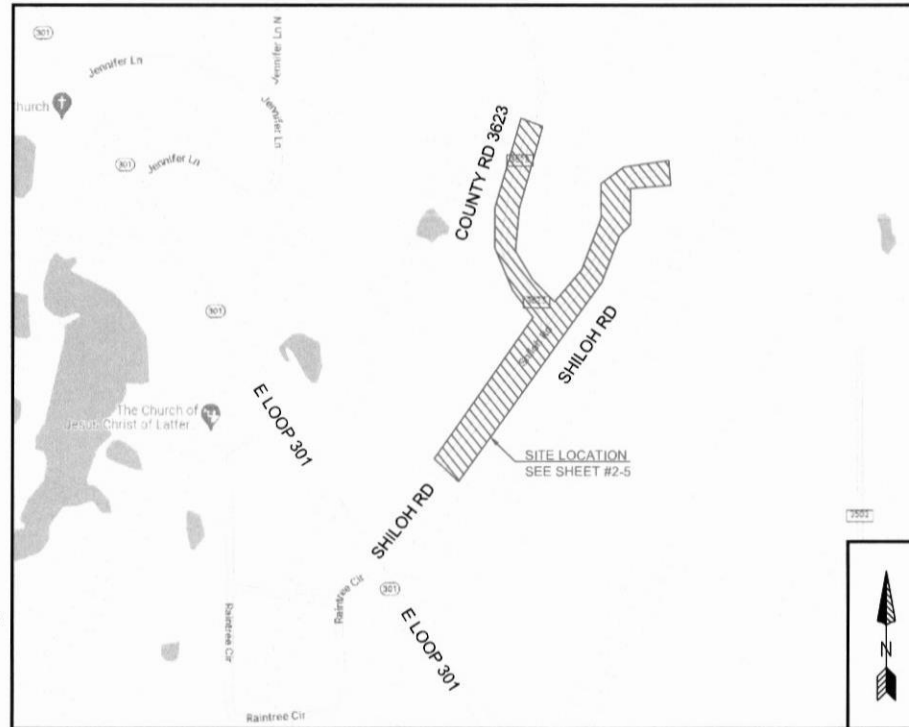

**VICINITY MAP
NTS**

ABBREVIATIONS

BLDG	BUILDING	PED	PEDESTAL (UTILITY)
C/L	CENTER LINE	PVC	POLYVINYL CHLORIDE
CONC	CONCRETE	P/L	PROPERTY LINE
CSW	CONCRETE SIDEWALK	RR	RAILROAD
DWY	DRIVEWAY	R/W	RIGHT OF WAY
EOC	EDGE OF CURB	SL	STREET LIGHT
EOP	EDGE OF PAVEMENT	W-BLDG	WALL TO BUILDING
ETW	ETW LINE	W-P	WALL TO POLE
HH	HANDHOLE	W-W	WALL TO WALL
MH	MANHOLE	P.U.E.	PUBLIC UTILITY EASEMENT
NTS	NOT TO SCALE	C/G	CURB AND GUTTER

LEGEND

	New Trench
	New Bore
	Existing Gas
	Existing Water
	Existing Telephone
	Existing Sewer
	Existing Storm Drain
	Existing Electric
	Existing Manhole
	Existing Handhole (2'x3' or 17'x30')
	DSLAM
	X-CONNECT
	POWER PEDESTAL
	TELCO PEDESTAL
	3' X 5' PULL BOX
	POLE



JOB ID: 5295333	DATE: 04/10/2022
TITLE: 200 SHILOH RD	
STREET ADDRESS: 200 SHILOH RD	
CITY/STATE: SULPHUR SPRINGS, TX 75482 (HOPKINS COUNTY)	
FTR ENGINEER: CORY RIGGS (310) 210-9882	
FTR INSPECTOR: JAMES WEST (972) 578-3224	
ENGINEERED BY: CHC CONSULTING	DRAWN BY: CHC CONSULTING
EST. #:	SHEET#:
1005 RIO SAN DIEGO DR, STE 400 SAN DIEGO, CA 92108	1 OF 6

-HDPE AND PVC FOOTAGES DO NOT INCLUDE SWEEPS
-ACTUAL FOOTAGES OF HDPE AND PVC WILL BE NEEDED TO ORDER MATERIALS. PLEASE INCLUDE MEASURED TAPE IN ALL PVC'S.
-FRONTIER INSPECTOR SHALL BE PRESENT ON SITE WHEN CONTRACTOR NEEDS TO ACCESS ANY EXISTING FRONTIER FACILITY.



Know what's below.
Call before you dig.

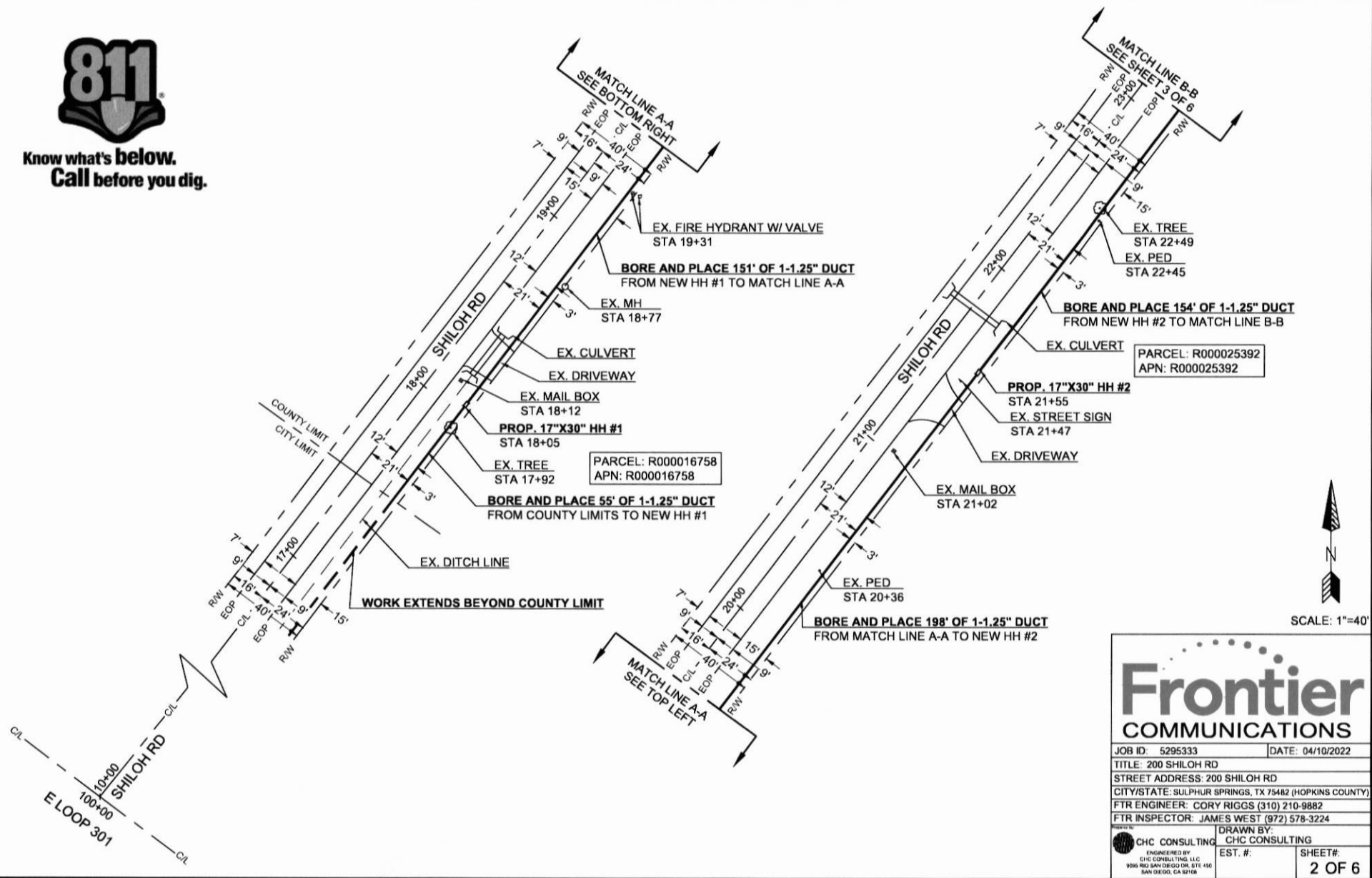

SCALE: 1"=40'

Frontier
COMMUNICATIONS

JOB ID: 5295333 DATE: 04/10/2022

TITLE: 200 SHILOH RD

STREET ADDRESS: 200 SHILOH RD

CITY/STATE: SULPHUR SPRINGS, TX 75482 (HOPKINS COUNTY)

FTR ENGINEER: CORY RIGGS (310) 210-9882

FTR INSPECTOR: JAMES WEST (972) 578-3224

DRAWN BY: CHC CONSULTING
EST. #: SHEET#:

2 OF 6

CURVE	RADIUS	LENGTH	DELTA
C1	25'	47'	107°
C2	3'	5'	90°

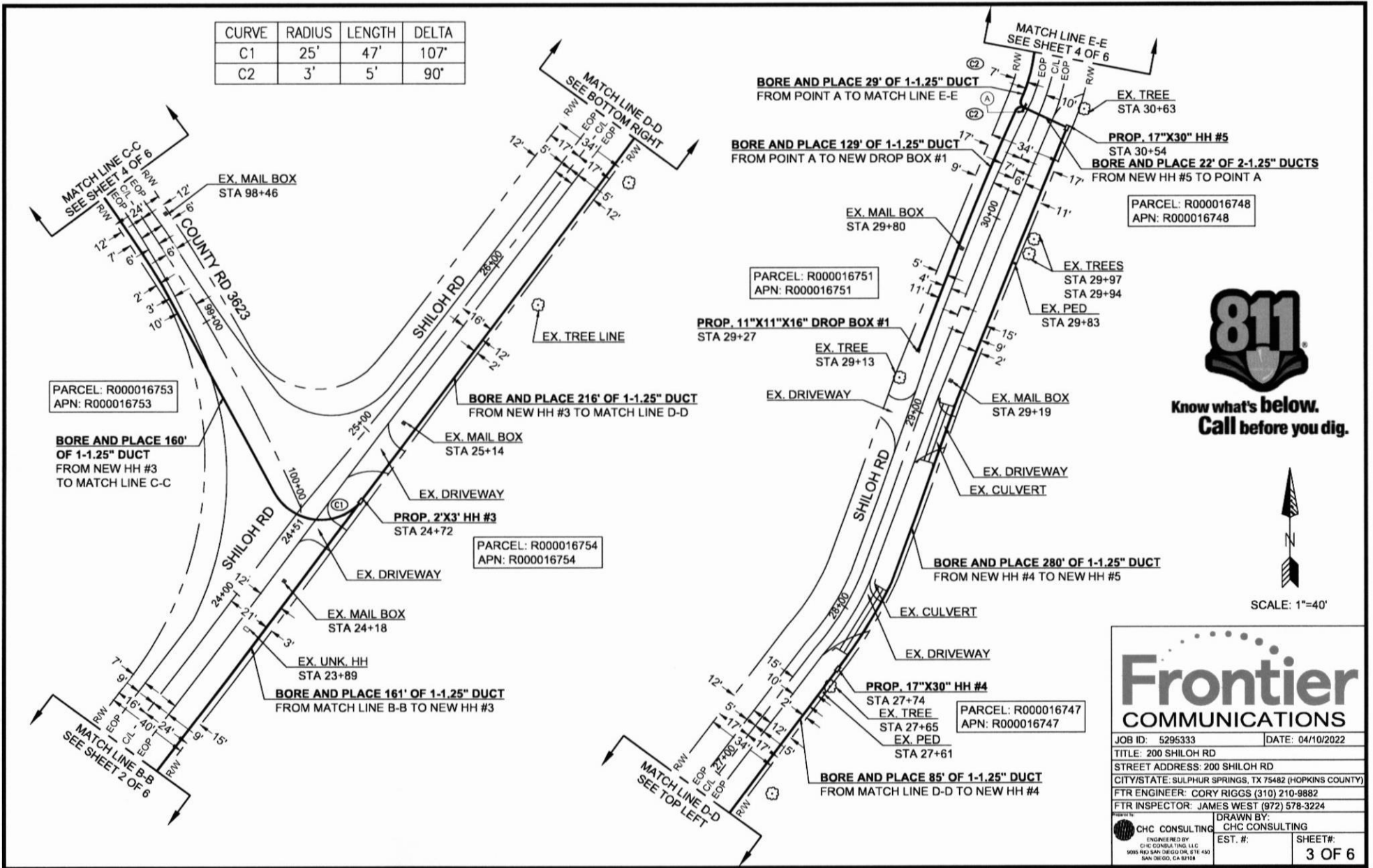

Know what's below.
Call before you dig.



SCALE: 1"=40'

Frontier
COMMUNICATIONS

JOB ID: 5295333 DATE: 04/10/2022
 TITLE: 200 SHILOH RD
 STREET ADDRESS: 200 SHILOH RD
 CITY/STATE: SULPHUR SPRINGS, TX 75482 (HOPKINS COUNTY)
 FTR ENGINEER: CORY RIGGS (310) 210-9882
 FTR INSPECTOR: JAMES WEST (972) 578-3224

CHC CONSULTING ENGINEERED BY CHC CONSULTING LLC 9090 RED SAN DIEGO DR, STE 400 SAN DIEGO, CA 92158	DRAWN BY: CHC CONSULTING EST. #: SHEET#: 3 OF 6
--	--

CURVE	RADIUS	LENGTH	DELTA
C1	6'	9'	90°

PARCEL: R000016751
APN: R000016751

PROP. 11"X11"X16" DROP BOX #2
STA 33+69

EX. STREET LIGHT
STA 33+96

EX. STREET LIGHT
STA 32+49



Know what's below.
Call before you dig.



SCALE: 1"=40'

Frontier COMMUNICATIONS

JOB ID: 5295333 DATE: 04/10/2022
TITLE: 200 SHILOH RD
STREET ADDRESS: 200 SHILOH RD
CITY/STATE: SULPHUR SPRINGS, TX 75482 (HOPKINS COUNTY)
FTR ENGINEER: CORY RIGGS (310) 210-9882
FTR INSPECTOR: JAMES WEST (972) 578-3224

CHC CONSULTING DRAWN BY: CHC CONSULTING
EST. #:
SHEET #:
4 OF 6

MATCH LINE F-F
SEE SHEET 5 OF 6

BORE AND PLACE 55' OF 1-1.25" DUCT
FROM NEW HH #7 TO MATCH LINE F-F

PROP. 17"X30" HH #7
STA 94+92

PARCEL: R000016745
APN: R000016745

PARCEL: R000027809
APN: R000027809

BORE AND PLACE 284' OF 1-1.25" DUCT
FROM NEW HH #6 TO NEW HH #7

BORE AND PLACE 301' OF 1-1.25" DUCT
FROM MATCH LINE E-E TO NEW DROP BOX #2

EX. MAIL BOXES
STA 97+25

PARCEL: R000016745
APN: R000016745

PROP. 17"X30" HH #6
STA 97+68

BORE AND PLACE 54' OF 1-1.25" DUCT
FROM MATCH LINE C-C TO NEW HH #6

MATCH LINE C-C
SEE SHEET 3 OF 6

MATCH LINE E-E
SEE SHEET 3 OF 6

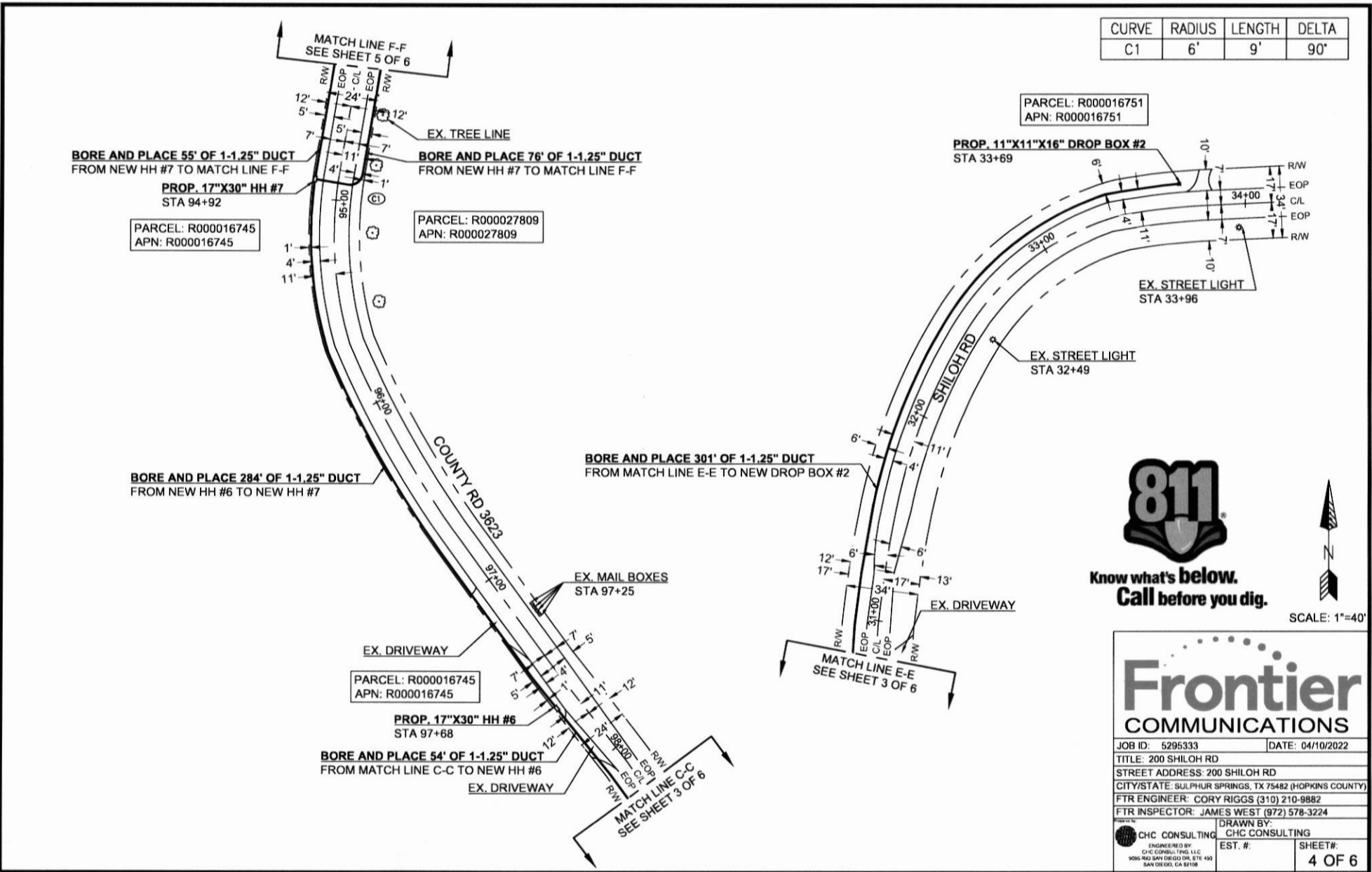

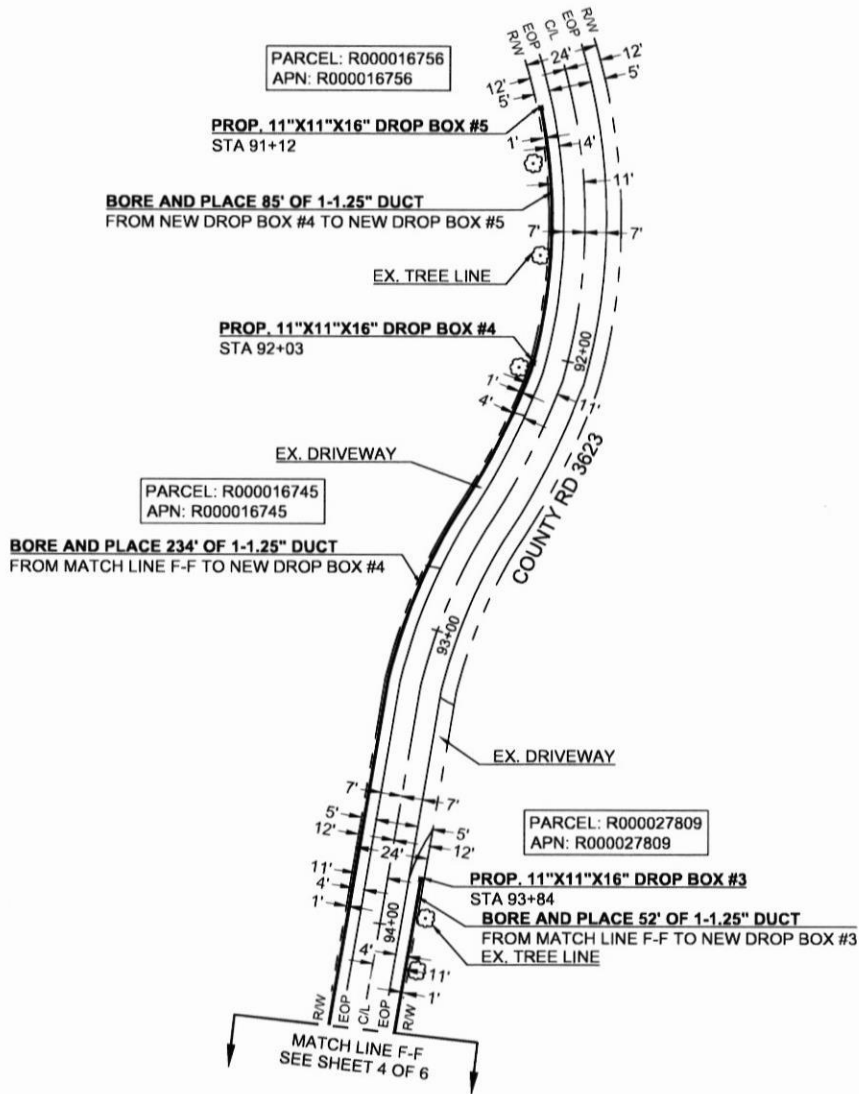

Know what's below.
Call before you dig.



SCALE: 1"=40'

Frontier COMMUNICATIONS	
JOB ID: 5295333	DATE: 04/10/2022
TITLE: 200 SHILOH RD	
STREET ADDRESS: 200 SHILOH RD	
CITY/STATE: SULPHUR SPRINGS, TX 75482 (HOPKINS COUNTY)	
FTR ENGINEER: CORY RIGGS (310) 210-9882	
FTR INSPECTOR: JAMES WEST (972) 578-3224	
CHC CONSULTING <small>ENGINEERED BY CHC CONSULTING, LLC 9095 RIO SAN DIEGO DR. STE 450 SAN DIEGO, CA 92126</small>	DRAWN BY: CHC CONSULTING EST. #: SHEET#: 5 OF 6

MINIMUM STANDARDS FOR DIRECTIONAL BORING

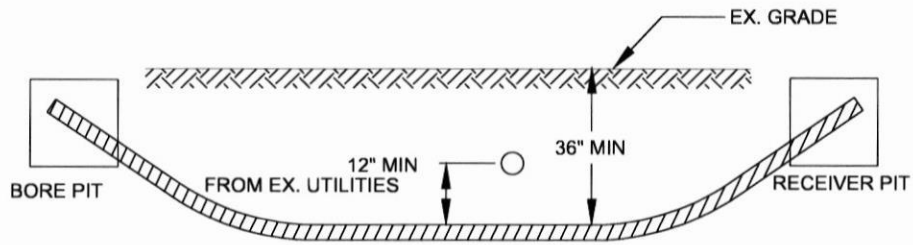

- PLACE END MARKER WITH UTILITY OWNER'S NAME DESCRIBING CONDUIT
- BORE PIT TO BE BACKFILLED AND COMPACTED IN 12" LIFTS WITH MATERIAL REMOVED
- FLOW OF DITCH MUST BE MAINTAINED AT ALL TIMES
- PROTECT ROOTS AT ALL TREE LOCATIONS, SHIFT BORE TRENCH IF NECESSARY

TYPICAL BORE DETAIL

SCALE
N.T.S. 1

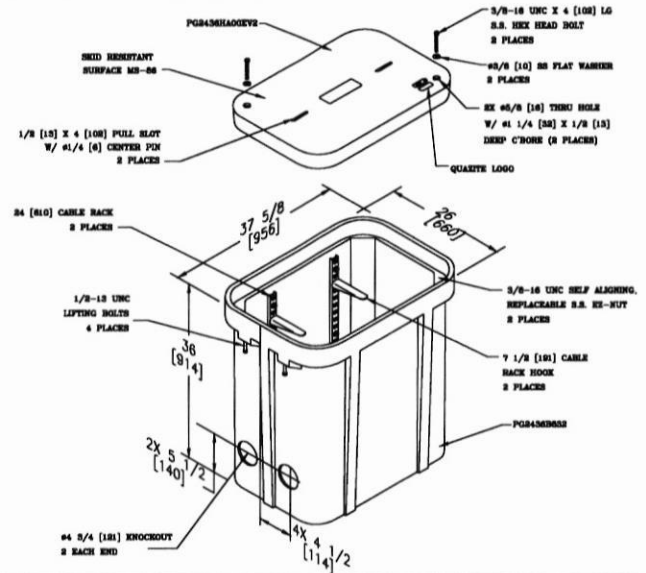

2' X 3' HAND HOLE

SCALE
N.T.S. 2

JOB ID: 5295333		DATE: 04/10/2022	
TITLE: 200 SHILOH RD			
STREET ADDRESS: 200 SHILOH RD			
CITY/STATE: SULPHUR SPRINGS, TX 75482 (HOPKINS COUNTY)			
FTR ENGINEER: CORY RIGGS (310) 210-9882			
FTR INSPECTOR: JAMES WEST (972) 578-3224			
DRAWN BY: CHC CONSULTING		EST. #:	
CHC CONSULTING ENGINEERED BY: CHC CONSULTING, LLC 9095 RIO SAN DIEGO DR, STE 410 SAN DIEGO, CA 92108		SHEET#: 6 OF 6	

Spectrum

NOTE
 CONTRACTOR IS RESPONSIBLE TO MAINTAIN TRAFFIC CONTROL AS SET FORTH IN THE TEXAS MANUAL ON UNIFORM TRAFFIC CONTROL DEVICES FOR STREETS AND HIGHWAYS

Hopkins County Road Power Supply

Project consist of approximately:
 approx. 8'-10' coax aerial drop to newly placed meter base pole with meter for power supply.

GENERAL CONSTRUCTION NOTES

1. ALL CONSTRUCTION WORK WITHIN THE PUBLIC RIGHT-OF-WAY SHALL BE DONE IN ACCORDANCE WITH THE ORDINANCES AND REGULATIONS OF THE MUNICIPALITY IN WHICH THE WORK IS TO BE PERFORMED.
2. EXISTING UTILITY LOCATIONS SHOWN ARE TAKEN FROM AVAILABLE RECORDS AND MAY NOT BE ALL INCLUSIVE. UTILITY LOCATIONS ARE GENERALLY SCHEMATIC IN NATURE AND MAY NOT ACCURATELY REFLECT THE SIZE AND LOCATION OF EACH PARTICULAR UTILITY. THE CONSTRUCTION CONTRACTOR SHALL ASSUME RESPONSIBILITY FOR ACTUAL LINE LOCATES IN THE FIELD AND THE PROTECTION OF ALL EXISTING FACILITIES WHETHER SHOWN OR NOT. THE CONSTRUCTION CONTRACTOR SHALL ALSO ASSUME RESPONSIBILITY FOR REPAIRS TO ANY EXISTING FACILITY DAMAGED AS A DIRECT RESULT OF THE CONSTRUCTION ACTIVITIES WHETHER THE FACILITY IS SHOWN ON THE DRAWINGS OR NOT.
3. THE CONSTRUCTION CONTRACTOR SHALL BE RESPONSIBLE FOR CONTACTING ALL DEPARTMENTS WITHIN THE MUNICIPALITY AND THE UTILITY COMPANIES AT LEAST TWO WORKING DAYS PRIOR TO THE COMMENCEMENT OF WORK.
 CALL BEFORE YOU DIG
 811
 IT'S THE LAW
4. IT SHALL BE THE RESPONSIBILITY OF THE CONSTRUCTION CONTRACTOR TO: A) PREVENT DAMAGE TO PRIVATE AND PUBLIC PROPERTY; B) RESTORE ALL AREAS EFFECTED BY THE CONSTRUCTION TO ORIGINAL OR BETTER CONDITION.
5. BARRICADE AND TRAFFIC CONTROL SHALL BE THE RESPONSIBILITY OF THE CONSTRUCTION CONTRACTOR AND SHALL CONFORM TO THE TEXAS MANUAL ON UNIFORM TRAFFIC CONTROL DEVICES' TRAFFIC FLOW AND ACCESS SHALL BE MAINTAINED DURING ALL PHASES OF CONSTRUCTION. THE CONSTRUCTION CONTRACTOR IS RESPONSIBLE FOR PREVENTING TRAFFIC SAFETY MEASURES FOR WORK ON THE PROJECT. THE WORK SITE SHALL BE SUITABLY LIT AND BARRICADED AT NIGHT.
6. THE CONSTRUCTION CONTRACTOR SHALL ABIDE BY ALL APPLICABLE FEDERAL, STATE AND LOCAL LAWS GOVERNING EXCAVATION. THE CONSTRUCTION CONTRACTOR SHALL PROVIDE ALL TRENCH SAFETY SYSTEMS THAT COMPLY WITH ALL LAWS GOVERNING EXCAVATION. THE CONSTRUCTION CONTRACTOR SHALL BE SOLELY RESPONSIBLE FOR ALL ASPECTS OF WORK RELATED TO EXCAVATION.
7. ALL CONCRETE USED IN ANY ROADWAY SHALL BE IN COMPLIANCE WITH THE SPECIFIED CLASSES OF CONCRETE IN THE STANDARD SPECIFICATIONS 5.8 "PORTLAND CEMENT CONCRETE PAVEMENT" AND 7.4.5 "QUALITY OF CONCRETE" AS AMENDED BY THE ADDENDUM TO THE NORTH-CENTRAL TEXAS STANDARD SPECIFICATIONS FOR PUBLIC WORKS CONSTRUCTION - 2004. ALL OTHER CONCRETE SHALL BE CLASS A CONCRETE.
8. ALL REINFORCING STEEL AND DOWEL BARS IN PAVEMENT SHALL BE SUPPORTED AND MAINTAINED AT THE CORRECT CLEARANCES BY THE USE OF BAR CHAINS OR OTHER APPROVED SUPPORT.
9. ALL CONDUIT MUST BE PLACED WITH A MINIMUM 42" OF COVER, UNLESS OTHERWISE SPECIFIED.
10. ALL BACKFILLING WILL BE MECHANICALLY TAMPED IN LIFTS TO A DENSITY OF 90% PROCTOR. THE REQUIRED DENSITY WILL BE OBTAINED BY USING TAMPERS, RAMMERS OR ROLLING EQUIPMENT. LIFTS MAY VARY ACCORDING TO THE TYPE OF EQUIPMENT USED TO OBTAIN THE REQUIRED DENSITY. SAND AND DEBRIS FREE MATERIAL WILL BE USED FOR BACKFILL.

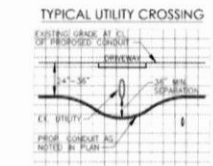
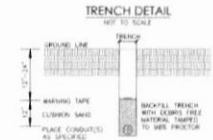

UNDERGROUND CONDUIT 1-2" HDPE

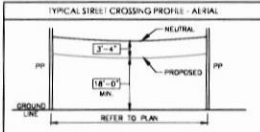

PREPARED BY: DFW TELECOM, INC



1565 Chenault Street, Dallas, Texas 75228

April 14, 2022

Office of Hopkins County Judge
PO BOX 288
Sulphur Springs, Texas 75483

**Aerial and / or Ground Mount Power Supply
Project PID 3540082**

Greetings,

Spectrum/Charter is requesting permission to construct and placement of meter base pole or ground mount meter base which may consist of either or both underground and aerial attachment to new meter base pole (approx. 12' tall from ground) or ground mount meter base. This request is for placement on county road 4360 which is located in Hopkins County, Texas.

Site location map and google plans are enclosed. The construction plans detail the proposed work.

If you have any questions, please contact me at any time.

Sincerely,

Darrin Wallace

Project Coordinator
darrin.wallace@charter.com
Phone 214-288-9549

Submitted by:

Dayna LaPoma / Jessie Hatley
Project Coordinator / RDOF Coordinator
Dayna.lapoma@dfw-telecom.com
Jessie.hatley@dfw-telecom.com

Enclosures

County Approval Section:

Approved: *OK*

Denied: _____

Authorized Signature: *Jessie Hatley*

Date: 4-18-22

Spectrum

NOTE
 CONTRACTOR IS RESPONSIBLE TO MAINTAIN TRAFFIC CONTROL AS SET FORTH IN THE TEXAS MANUAL ON UNIFORM TRAFFIC CONTROL DEVICES FOR STREETS AND HIGHWAYS

Hopkins County Road Power Supply

Project consist of approximately:
 approx. 8'-10' coax aerial drop to newly placed meter base pole with meter for power supply.

GENERAL CONSTRUCTION NOTES

1. ALL CONSTRUCTION WORK WITHIN THE PUBLIC RIGHT-OF-WAY SHALL BE DONE IN ACCORDANCE WITH THE ORDINANCES AND REGULATIONS OF THE MUNICIPALITY IN WHICH THE WORK IS TO BE PERFORMED.
2. EXISTING UTILITY LOCATIONS SHOWN ARE TAKEN FROM AVAILABLE RECORDS AND MAY NOT BE ALL. INCLUDE UTILITY LOCATIONS ARE GENERALLY SCHEMATIC IN NATURE AND MAY NOT ACCURATELY REFLECT THE SIZE AND LOCATION OF EACH PARTICULAR UTILITY. THE CONSTRUCTION CONTRACTOR SHALL ASSUME RESPONSIBILITY FOR ACTUAL LINE LOCATES IN THE FIELD AND THE PROTECTION OF ALL EXISTING FACILITIES WHETHER SHOWN OR NOT. THE CONSTRUCTION CONTRACTOR SHALL ALSO ASSUME RESPONSIBILITY FOR REPAIRS TO ANY EXISTING FACILITY DAMAGED AS A DIRECT RESULT OF THE CONSTRUCTION ACTIVITIES WHETHER THE FACILITY IS SHOWN ON THE DRAWINGS OR NOT.
3. THE CONSTRUCTION CONTRACTOR SHALL BE RESPONSIBLE FOR CONTACTING ALL DEPARTMENTS WITHIN THE MUNICIPALITY AND THE UTILITY COMPANIES AT LEAST TWO WORKING DAYS PRIOR TO THE COMMENCEMENT OF WORK.
 CALL BEFORE YOU DIG
 811
 IT'S THE LAW
4. IT SHALL BE THE RESPONSIBILITY OF THE CONSTRUCTION CONTRACTOR TO: A) PREVENT DAMAGE TO PRIVATE AND PUBLIC PROPERTY; B) RESTORE ALL AREAS EFFECTED BY THE CONSTRUCTION TO ORIGINAL OR BETTER CONDITION.
5. BARRICADING AND TRAFFIC CONTROL SHALL BE THE RESPONSIBILITY OF THE CONSTRUCTION CONTRACTOR AND SHALL CONFORM TO THE TEXAS MANUAL ON UNIFORM TRAFFIC CONTROL DEVICES. TRAFFIC FLOW AND ACCESS SHALL BE MAINTAINED DURING ALL PHASES OF CONSTRUCTION. THE CONSTRUCTION CONTRACTOR IS RESPONSIBLE FOR PROVIDING TRAFFIC SAFETY MEASURES FOR WORK ON THE PROJECT. THE WORK SITE SHALL BE SUITABLY LIT AND BARRICADED AT NIGHT.
6. THE CONSTRUCTION CONTRACTOR SHALL ABIDE BY ALL APPLICABLE FEDERAL, STATE AND LOCAL LAWS GOVERNING EXCAVATION. THE CONSTRUCTION CONTRACTOR SHALL PROVIDE ALL TRENCH SAFETY SYSTEMS THAT COMPLY WITH ALL LAWS GOVERNING EXCAVATION. THE CONSTRUCTION CONTRACTOR SHALL BE SOLELY RESPONSIBLE FOR ALL ASPECTS OF WORK RELATED TO EXCAVATION.
7. ALL CONCRETE USED IN ANY ROADWAY SHALL BE IN COMPLIANCE WITH THE SPECIFIED CLASSES OF CONCRETE IN THE STANDARD SPECIFICATIONS 5.8 "PORTLAND CEMENT CONCRETE PAVEMENT" AND 7.4.5 "QUALITY OF CONCRETE" AS AMENDED BY THE ADDENDUM TO THE NORTH-CENTRAL TEXAS STANDARD SPECIFICATIONS FOR PUBLIC WORKS CONSTRUCTION - 2004. ALL OTHER CONCRETE SHALL BE CLASS A CONCRETE.
8. ALL REINFORCING STEEL AND DOWEL BARS IN PAVEMENT SHALL BE SUPPORTED AND MAINTAINED AT THE CORRECT CLEARANCES BY THE USE OF BAR CHAINS OR OTHER APPROVED SUPPORT.
9. ALL CONDUIT MUST BE PLACED WITH A MINIMUM 42" OF COVER, UNLESS OTHERWISE SPECIFIED.
10. ALL BACKFILLING WILL BE MECHANICALLY TAMPED IN LIFTS TO A DENSITY OF 95% PROCTOR. THE REQUIRED DENSITY WILL BE OBTAINED BY USING TAMPERS, RAMMERS OR ROLLING EQUIPMENT. LIFTS MAY VARY ACCORDING TO THE TYPE OF EQUIPMENT USED TO OBTAIN THE REQUIRED DENSITY. SAND AND DEBRIS FREE MATERIAL WILL BE USED FOR BACKFILL.

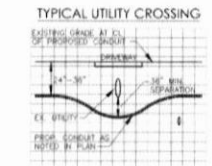
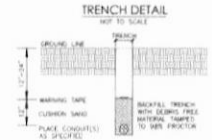

UNDERGROUND CONDUIT 1-2" HDPE

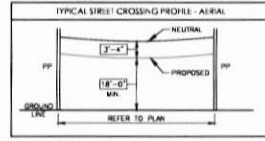



1565 Chenault Street, Dallas, Texas 75228

April 14, 2022

Office of Hopkins County Judge
PO BOX 288
Sulphur Springs, Texas 75483

**Underground Parallel &/OR Crossing(s)
Project PID 3275582**

Greetings,

Spectrum/Charter is requesting permission to construct and placement of underground conduit and fiber. This request is for proposed construction county road 4711, county road 4712, county road 4700, which is located in Hopkins County, Texas.

Site location map and google plans are enclosed. The construction plans detail the proposed work.

If you have any questions, please contact me at any time.

Sincerely,

Jason Kennedy

Project Coordinator

jason.kennedy@charter.com

Phone 903-513-2738

Submitted by:

Dayna LaPoma / Jessie Hatley
Project Coordinator / RDOF Coordinator

Dayna.lapoma@dfw-telecom.com

Jessie.hatley@dfw-telecom.com

Enclosures

County Approval Section:

Approved: OK

Denied: _____

Authorized Signature: *Jessie Hatley*

Date: 4-18-22



Hopkins County

NOTE
 CONTRACTOR IS RESPONSIBLE TO MAINTAIN TRAFFIC CONTROL AS SET FORTH IN THE TEXAS MANUAL ON UNIFORM TRAFFIC CONTROL DEVICES FOR STREETS AND HIGHWAYS

Hopkins County Notes: Bore only no trenching and the conduit placement should be the backside of ditch away from the county road when running parallel to the CR

Project consist of approximately:
 2,740' Underground on CR 4711
 2,431' Underground on CR 4712
 1,803' Underground on CR 4700

GENERAL CONSTRUCTION NOTES

1. ALL CONSTRUCTION WORK WITHIN THE PUBLIC RIGHT-OF-WAY SHALL BE DONE IN ACCORDANCE WITH THE ORDINANCES AND REGULATIONS OF THE MUNICIPALITY IN WHICH THE WORK IS TO BE PERFORMED.
2. EXISTING UTILITY LOCATIONS SHOWN ARE TAKEN FROM AVAILABLE RECORDS AND MAY NOT BE ALL INCLUSIVE. UTILITY LOCATIONS ARE GENERALLY SCHEMATIC IN NATURE AND MAY NOT ACCURATELY REFLECT THE SIZE AND LOCATION OF EACH PARTICULAR UTILITY. THE CONSTRUCTION CONTRACTOR SHALL ASSUME RESPONSIBILITY FOR ACTUAL LINE LOCATED IN THE FIELD AND THE PROTECTION OF ALL EXISTING FACILITIES WHETHER SHOWN OR NOT. THE CONSTRUCTION CONTRACTOR SHALL ALSO ASSUME RESPONSIBILITY FOR REPAIRS TO ANY EXISTING FACILITY DAMAGED AS A DIRECT RESULT OF THE CONSTRUCTION ACTIVITIES WHETHER THE FACILITY IS SHOWN ON THE DRAWINGS OR NOT.
3. THE CONSTRUCTION CONTRACTOR SHALL BE RESPONSIBLE FOR CONTACTING ALL DEPARTMENTS WITHIN THE MUNICIPALITY AND THE UTILITY COMPANIES AT LEAST TWO WORKING DAYS PRIOR TO THE COMMENCEMENT OF WORK.
 CALL BEFORE YOU DIG
 811
 IT'S THE LAW
4. IT SHALL BE THE RESPONSIBILITY OF THE CONSTRUCTION CONTRACTOR TO: A) PREVENT DAMAGE TO PRIVATE AND PUBLIC PROPERTY; B) RESTORE ALL AREAS EFFECTED BY THE CONSTRUCTION TO ORIGINAL OR BETTER CONDITION.
5. BARRICADE AND TRAFFIC CONTROL SHALL BE THE RESPONSIBILITY OF THE CONSTRUCTION CONTRACTOR AND SHALL CONFORM TO THE "TEXAS MANUAL ON UNIFORM TRAFFIC CONTROL DEVICES". TRAFFIC FLOW AND ACCESS SHALL BE MAINTAINED DURING ALL PHASES OF CONSTRUCTION. THE CONSTRUCTION CONTRACTOR IS RESPONSIBLE FOR PROVIDING TRAFFIC SAFETY MEASURES FOR WORK ON THE PROJECT. THE WORK SITE SHALL BE SUITABLY LIT AND BARRICADED AT NIGHT.
6. THE CONSTRUCTION CONTRACTOR SHALL ABIDE BY ALL APPLICABLE FEDERAL, STATE AND LOCAL LAWS GOVERNING EXCAVATION. THE CONSTRUCTION CONTRACTOR SHALL PROVIDE ALL TRENCH SAFETY SYSTEMS THAT COMPLY WITH ALL LAWS GOVERNING EXCAVATION. THE CONSTRUCTION CONTRACTOR SHALL BE SOLELY RESPONSIBLE FOR ALL ASPECTS OF WORK RELATED TO EXCAVATION.
7. ALL CONCRETE USED IN ANY ROADWAY SHALL BE IN COMPLIANCE WITH THE SPECIFIED CLASSES OF CONCRETE IN THE STANDARD SPECIFICATIONS 5.8 "PORTLAND CEMENT CONCRETE PAVEMENT" AND 7.4.5 "QUALITY OF CONCRETE" AS AMENDED BY THE ADDENDUM TO THE NORTH-CENTRAL TEXAS STANDARD SPECIFICATIONS FOR PUBLIC WORKS CONSTRUCTION - 2004. ALL OTHER CONCRETE SHALL BE CLASS A CONCRETE.
8. ALL REINFORCING STEEL AND DOWEL BARS IN PAVEMENT SHALL BE SUPPORTED AND MAINTAINED AT THE CORRECT CLEARANCES BY THE USE OF BAR CHAINS OR OTHER APPROVED SUPPORT.
9. ALL CONDUIT MUST BE PLACED WITH A MINIMUM 42" OF COVER, UNLESS OTHERWISE SPECIFIED.
10. ALL BACKFILLING WILL BE MECHANICALLY TAMPED IN LIFTS TO A DENSITY OF 95% PROCTOR. THE REQUIRED DENSITY WILL BE OBTAINED BY USING TAMPERS, HAMMERS OR ROLLING EQUIPMENT. LIFTS MAY VARY ACCORDING TO THE TYPE OF EQUIPMENT USED TO OBTAIN THE REQUIRED DENSITY. SAND AND DEBRIS FREE MATERIAL WILL BE USED FOR BACKFILL.

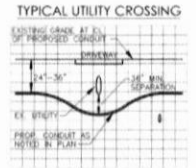

UNDERGROUND CONDUIT 1-2" HDPE

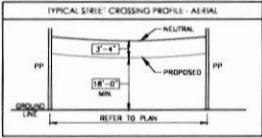

PREPARED BY: DFW TELECOM, INC



1565 Chenault Street, Dallas, Texas 75228

April 14, 2022

Office of Hopkins County Judge
PO BOX 288
Sulphur Springs, Texas 75483

**Underground Parallel &/OR Crossing(s)
Project PID 3275582**

Greetings,

Spectrum/Charter is requesting permission to construct and placement of underground conduit and fiber. This request is for proposed construction county road 4712, county road 4714, county road 4715, which is located in Hopkins County, Texas.

Site location map and google plans are enclosed. The construction plans detail the proposed work.

If you have any questions, please contact me at any time.

Sincerely,

Jason Kennedy

Project Coordinator

jason.kennedy@charter.com

Phone 903-513-2738

Submitted by:

Dayna LaPoma / Jessie Hatley

Project Coordinator / RDOF Coordinator

Dayna.lapoma@dfw-telecom.com

Jessie.hatley@dfw-telecom.com

Enclosures

County Approval Section:

Approved: OK

Denied: _____

Authorized Signature: *JoPise*

Date: 4-18-22



Hopkins County

NOTE
 CONTRACTOR IS RESPONSIBLE TO MAINTAIN TRAFFIC CONTROL AS SET FORTH IN THE TEXAS MANUAL ON UNIFORM TRAFFIC CONTROL DEVICES FOR STREETS AND HIGHWAYS

Hopkins County Notes: Bore only no trenching and the conduit placement should be the backside of ditch away from the county road when running parallel to the CR

Project consist of approximately:
 7,011' Underground on CR 4712
 2,128' Underground on CR 4715
 3,014' Underground on CR 4714

GENERAL CONSTRUCTION NOTES

1. ALL CONSTRUCTION WORK WITHIN THE PUBLIC RIGHT-OF-WAY SHALL BE DONE IN ACCORDANCE WITH THE ORDINANCES AND REGULATIONS OF THE MUNICIPALITY IN WHICH THE WORK IS TO BE PERFORMED.
2. EXISTING UTILITY LOCATIONS SHOWN ARE TAKEN FROM AVAILABLE RECORDS AND MAY NOT BE ALL INCLUSIVE. UTILITY LOCATIONS ARE GENERALLY SCHEMATIC IN NATURE AND MAY NOT ACCURATELY REFLECT THE SIZE AND LOCATION OF EACH PARTICULAR UTILITY. THE CONSTRUCTION CONTRACTOR SHALL ASSUME RESPONSIBILITY FOR ACTUAL LINE LOCATES IN THE FIELD AND THE PROTECTION OF ALL EXISTING FACILITIES WHETHER SHOWN OR NOT. THE CONSTRUCTION CONTRACTOR SHALL ALSO ASSUME RESPONSIBILITY FOR REPAIR TO ANY EXISTING FACILITY DAMAGED AS A DIRECT RESULT OF THE CONSTRUCTION ACTIVITIES WHETHER THE FACILITY IS SHOWN ON THE DRAWINGS OR NOT.
3. THE CONSTRUCTION CONTRACTOR SHALL BE RESPONSIBLE FOR CONTACTING ALL DEPARTMENTS WITHIN THE MUNICIPALITY AND THE UTILITY COMPANIES AT LEAST TWO WORKING DAYS PRIOR TO THE COMMENCEMENT OF WORK.
 CALL BEFORE YOU DIG
 811
 IT'S THE LAW
4. IT SHALL BE THE RESPONSIBILITY OF THE CONSTRUCTION CONTRACTOR TO: A) PREVENT DAMAGE TO PRIVATE AND PUBLIC PROPERTY; B) RESTORE ALL AREAS EFFECTED BY THE CONSTRUCTION TO ORIGINAL OR BETTER CONDITION.
5. BARRICADE AND TRAFFIC CONTROL SHALL BE THE RESPONSIBILITY OF THE CONSTRUCTION CONTRACTOR AND SHALL CONFORM TO THE TEXAS MANUAL ON UNIFORM TRAFFIC CONTROL DEVICES. TRAFFIC FLOW AND ACCESS SHALL BE MAINTAINED DURING ALL PHASES OF CONSTRUCTION. THE CONSTRUCTION CONTRACTOR IS RESPONSIBLE FOR PROVIDING TRAFFIC SAFETY MEASURES FOR WORK ON THE PROJECT. THE WORK SITE SHALL BE SUITABLY LIT AND BARRICADED AT NIGHT.
6. THE CONSTRUCTION CONTRACTOR SHALL ABIDE BY ALL APPLICABLE FEDERAL, STATE AND LOCAL LAWS GOVERNING EXCAVATION. THE CONSTRUCTION CONTRACTOR SHALL PROVIDE ALL TRENCH SAFETY SYSTEMS THAT COMPLY WITH ALL LAWS GOVERNING EXCAVATION. THE CONSTRUCTION CONTRACTOR SHALL BE SOLELY RESPONSIBLE FOR ALL ASPECTS OF WORK RELATED TO EXCAVATION.
7. ALL CONCRETE USED IN ANY ROADWAY SHALL BE IN COMPLIANCE WITH THE SPECIFIED CLASSES OF CONCRETE IN THE STANDARD SPECIFICATIONS 5.8 "PORTLAND CEMENT CONCRETE PAVEMENT" AND 7.4.5 "QUALITY OF CONCRETE" AS AMENDED BY THE ADDENDUM TO THE NORTH-CENTRAL TEXAS STANDARD SPECIFICATIONS FOR PUBLIC WORKS CONSTRUCTION - 2004. ALL OTHER CONCRETE SHALL BE CLASS A CONCRETE.
8. ALL REINFORCING STEEL AND DOWEL BARS IN PAVEMENT SHALL BE SUPPORTED AND MAINTAINED AT THE CORRECT CLEARANCES BY THE USE OF BAR CHAINS OR OTHER APPROVED SUPPORT.
9. ALL CONDUIT MUST BE PLACED WITH A MINIMUM 42" OF COVER, UNLESS OTHERWISE SPECIFIED.
10. ALL BACKFILLING WILL BE MECHANICALLY TAMPED IN LIFTS TO A DENSITY OF 90% PROCTOR. THE REQUIRED DENSITY WILL BE OBTAINED BY USING TAMPERS, RAMMERS OR ROLLING EQUIPMENT. LIFTS MAY VARY ACCORDING TO THE TYPE OF EQUIPMENT USED TO OBTAIN THE REQUIRED DENSITY. SAND AND DEBRIS FREE MATERIAL WILL BE USED FOR BACKFILL.



Legend

- Aerial Cable
- Down Guy
- Existing poles
- Underground

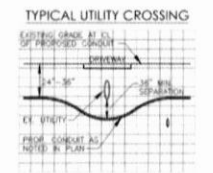

UNDERGROUND CONDUIT 1-2" HDPE

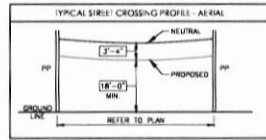

PREPARED BY: DFW TELECOM, INC



1565 Chenault Street, Dallas, Texas 75228

April 14, 2022

Office of Hopkins County Judge
PO BOX 288
Sulphur Springs, Texas 75483

**Underground Parallel &/OR Crossing(s)
Project PID 3275582**

Greetings,

Spectrum/Charter is requesting permission to construct and placement of underground conduit and fiber. This request is for proposed construction county road 4712 and county road 4719, which is located in Hopkins County, Texas.

Site location map and google plans are enclosed. The construction plans detail the proposed work.

If you have any questions, please contact me at any time.

Sincerely,

Jason Kennedy
Project Coordinator
jason.kennedy@charter.com
Phone 903-513-2738

Submitted by:

Dayna LaPoma / Jessie Hatley
Project Coordinator / RDOF Coordinator
Dayna.lapoma@dfw-telecom.com
Jessie.hatley@dfw-telecom.com

Enclosures

County Approval Section:

Approved: ✓ OK Denied: _____
Authorized Signature: *Dayna LaPoma* Date: 4-18-22



Hopkins County

NOTE
CONTRACTOR IS RESPONSIBLE TO MAINTAIN TRAFFIC CONTROL AS SET FORTH IN THE TEXAS MANUAL ON UNIFORM TRAFFIC CONTROL DEVICES FOR STREETS AND HIGHWAYS

Hopkins County Notes: Bore only no trenching and the conduit placement should be the backside of ditch away from the county road when running parallel to the CR

Project consist of approximately:
6,387' Underground on CR 4712
8,322' Underground on CR 4719

GENERAL CONSTRUCTION NOTES

1. ALL CONSTRUCTION WORK WITHIN THE PUBLIC RIGHT-OF-WAY SHALL BE DONE IN ACCORDANCE WITH THE ORDINANCES AND REGULATIONS OF THE MUNICIPALITY IN WHICH THE WORK IS TO BE PERFORMED.
2. EXISTING UTILITY LOCATIONS SHOWN ARE TAKEN FROM AVAILABLE RECORDS AND MAY NOT BE ALL INCLUSIVE. UTILITY LOCATIONS ARE GENERALLY SCHEMATIC IN NATURE AND MAY NOT ACCURATELY REFLECT THE SIZE AND LOCATION OF EACH PARTICULAR UTILITY. THE CONSTRUCTION CONTRACTOR SHALL ASSUME RESPONSIBILITY FOR ACTUAL LINE LOCATES IN THE FIELD AND THE PROTECTION OF ALL EXISTING FACILITIES WHETHER SHOWN OR NOT. THE CONSTRUCTION CONTRACTOR SHALL ALSO ASSUME RESPONSIBILITY FOR REPAIRS TO ANY EXISTING FACILITY DAMAGED AS A DIRECT RESULT OF THE CONSTRUCTION ACTIVITIES, WHETHER THE FACILITY IS SHOWN ON THE DRAWINGS OR NOT.
3. THE CONSTRUCTION CONTRACTOR SHALL BE RESPONSIBLE FOR CONTACTING ALL DEPARTMENTS WITHIN THE MUNICIPALITY AND THE UTILITY COMPANIES AT LEAST TWO WORKING DAYS PRIOR TO THE COMMENCEMENT OF WORK.
CALL BEFORE YOU DIG
811
IT'S THE LAW
4. IT SHALL BE THE RESPONSIBILITY OF THE CONSTRUCTION CONTRACTOR TO: A) PREVENT DAMAGE TO PRIVATE AND PUBLIC PROPERTY; B) RESTORE ALL AREAS EFFECTED BY THE CONSTRUCTION TO ORIGINAL OR BETTER CONDITION.
5. BARRICADING AND TRAFFIC CONTROL SHALL BE THE RESPONSIBILITY OF THE CONSTRUCTION CONTRACTOR AND SHALL CONFORM TO THE TEXAS MANUAL ON UNIFORM TRAFFIC CONTROL DEVICES. TRAFFIC FLOW AND ACCESS SHALL BE MAINTAINED DURING ALL PHASES OF CONSTRUCTION. THE CONSTRUCTION CONTRACTOR IS RESPONSIBLE FOR PROVIDING TRAFFIC SAFETY MEASURES FOR WORK ON THE PROJECT. THE WORK SITE SHALL BE SUITABLY LIT AND BARRICADED AT NIGHT.
6. THE CONSTRUCTION CONTRACTOR SHALL ABIDE BY ALL APPLICABLE FEDERAL, STATE AND LOCAL LAWS GOVERNING EXCAVATION. THE CONSTRUCTION CONTRACTOR SHALL PROVIDE ALL TRENCH SAFETY SYSTEMS THAT COMPLY WITH ALL LAWS GOVERNING EXCAVATION. THE CONSTRUCTION CONTRACTOR SHALL BE SOLELY RESPONSIBLE FOR ALL ASPECTS OF WORK RELATED TO EXCAVATION.
7. ALL CONCRETE USED IN ANY ROADWAY SHALL BE IN COMPLIANCE WITH THE SPECIFIED CLASSES OF CONCRETE IN THE STANDARD SPECIFICATIONS 5 B "PORTLAND CEMENT CONCRETE PAVEMENT" AND 7.4.5 "QUALITY OF CONCRETE" AS AMENDED BY THE ADDENDUM TO THE NORTH CENTRAL TEXAS STANDARD SPECIFICATIONS FOR PUBLIC WORKS CONSTRUCTION - 2004. ALL OTHER CONCRETE SHALL BE CLASS A CONCRETE.
8. ALL REINFORCING STEEL AND DOWEL BARS IN PAVEMENT SHALL BE SUPPORTED AND MAINTAINED AT THE CORRECT CLEARANCES BY THE USE OF BAR CHAINS OR OTHER APPROVED SUPPORT.
9. ALL CONDUIT MUST BE PLACED WITH A MINIMUM 42" OF COVER, UNLESS OTHERWISE SPECIFIED.
10. ALL BACKFILLING WILL BE MECHANICALLY TAMPED IN LIFTS TO A DENSITY OF 95% PROCTOR. THE REQUIRED DENSITY WILL BE OBTAINED BY USING TAMPERS, RAMMERS OR ROLLING EQUIPMENT. LIFTS MAY VARY ACCORDING TO THE TYPE OF EQUIPMENT USED TO OBTAIN THE REQUIRED DENSITY. SAND AND DEBRIS FREE MATERIAL WILL BE USED FOR BACKFILL.

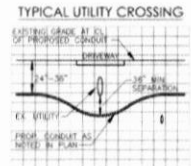

UNDERGROUND CONDUIT 1-2" HDPE

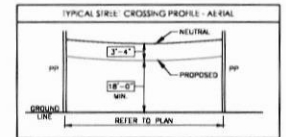

PREPARED BY: DFW TELECOM, INC



1565 Chenault Street, Dallas, Texas 75228

April 14, 2022

Office of Hopkins County Judge
PO BOX 288
Sulphur Springs, Texas 75483

**Underground Parallel &/OR Crossing(s)
Project PID 3275582**

Greetings,

Spectrum/Charter is requesting permission to construct and placement of underground conduit and fiber. This request is for proposed construction county road 4717, which is located in Hopkins County, Texas.

Site location map and google plans are enclosed. The construction plans detail the proposed work.

If you have any questions, please contact me at any time.

Sincerely,

Jason Kennedy

Project Coordinator

jason.kennedy@charter.com

Phone 903-513-2738

Submitted by:

Dayna LaPoma / Jessie Hatley

Project Coordinator / RDOF Coordinator

Dayna.lapoma@dfw-telecom.com

Jessie.hatley@dfw-telecom.com

Enclosures

County Approval Section:

Approved: *ok*

Denied: _____

Authorized Signature: *John*

Date: 4-18-22



Hopkins County

NOTE
CONTRACTOR IS RESPONSIBLE TO MAINTAIN TRAFFIC CONTROL AS SET FORTH IN THE TEXAS MANUAL ON UNIFORM TRAFFIC CONTROL DEVICES FOR STREETS AND HIGHWAYS

Hopkins County Notes: Bore only no trenching and the conduit placement should be the backside of ditch away from the county road when running parallel to the CR

Project consist of approximately:
4,689' Underground on CR 4717

GENERAL CONSTRUCTION NOTES

1. ALL CONSTRUCTION WORK WITHIN THE PUBLIC RIGHT-OF-WAY SHALL BE DONE IN ACCORDANCE WITH THE ORDINANCES AND REGULATIONS OF THE MUNICIPALITY IN WHICH THE WORK IS TO BE PERFORMED.
2. EXISTING UTILITY LOCATIONS SHOWN ARE TAKEN FROM AVAILABLE RECORDS AND MAY NOT BE ALL INCLUSIVE. UTILITY LOCATIONS ARE GENERALLY SCHEMATIC IN NATURE AND MAY NOT ACCURATELY REFLECT THE SIZE AND LOCATION OF EACH PARTICULAR UTILITY. THE CONSTRUCTION CONTRACTOR SHALL ASSUME RESPONSIBILITY FOR ACTUAL LINE LOCATES IN THE FIELD AND THE PROTECTION OF ALL EXISTING FACILITIES WHETHER SHOWN OR NOT. THE CONSTRUCTION CONTRACTOR SHALL ALSO ASSUME RESPONSIBILITY FOR REPAIRS TO ANY EXISTING FACILITY DAMAGED AS A DIRECT RESULT OF THE CONSTRUCTION ACTIVITIES WHETHER THE FACILITY IS SHOWN ON THE DRAWINGS OR NOT.
3. THE CONSTRUCTION CONTRACTOR SHALL BE RESPONSIBLE FOR CONTACTING ALL DEPARTMENTS WITHIN THE MUNICIPALITY AND THE UTILITY COMPANIES AT LEAST TWO WORKING DAYS PRIOR TO THE COMMENCEMENT OF WORK.
CALL BEFORE YOU DIG
811
IT'S THE LAW
4. IT SHALL BE THE RESPONSIBILITY OF THE CONSTRUCTION CONTRACTOR TO: A) PREVENT DAMAGE TO PRIVATE AND PUBLIC PROPERTY; B) RESTORE ALL AREAS EFFECTED BY THE CONSTRUCTION TO ORIGINAL OR BETTER CONDITION.
5. BARRICADE AND TRAFFIC CONTROL SHALL BE THE RESPONSIBILITY OF THE CONSTRUCTION CONTRACTOR AND SHALL CONFORM TO THE "TEXAS MANUAL ON UNIFORM TRAFFIC CONTROL DEVICES" TRAFFIC FLOW AND ACCESS SHALL BE MAINTAINED DURING ALL PHASES OF CONSTRUCTION. THE CONSTRUCTION CONTRACTOR IS RESPONSIBLE FOR PROVIDING TRAFFIC SAFETY MEASURES FOR WORK ON THE PROJECT. THE WORK SITE SHALL BE SUITABLY LIT AND BARRICADED AT NIGHT.
6. THE CONSTRUCTION CONTRACTOR SHALL ABIDE BY ALL APPLICABLE FEDERAL, STATE AND LOCAL LAWS GOVERNING EXCAVATION. THE CONSTRUCTION CONTRACTOR SHALL PROVIDE ALL TRENCH SAFETY SYSTEMS THAT COMPLY WITH ALL LAWS GOVERNING EXCAVATION. THE CONSTRUCTION CONTRACTOR SHALL BE SOLELY RESPONSIBLE FOR ALL ASPECTS OF WORK RELATED TO EXCAVATION.
7. ALL CONCRETE USED IN ANY ROADWAY SHALL BE IN COMPLIANCE WITH THE SPECIFIED CLASSES OF CONCRETE IN THE STANDARD SPECIFICATIONS 3.8 "PORTLAND CEMENT CONCRETE PAVEMENT" AND 7.4.5 "QUALITY OF CONCRETE" AS AMENDED BY THE ADDENDUM TO THE NORTH CENTRAL TEXAS STANDARD SPECIFICATIONS FOR PUBLIC WORKS CONSTRUCTION - 2004. ALL OTHER CONCRETE SHALL BE CLASS A CONCRETE.
8. ALL REINFORCING STEEL AND DOWEL BARS IN PAVEMENT SHALL BE SUPPORTED AND MAINTAINED AT THE CORRECT CLEARANCES BY THE USE OF BAR CHAINS OR OTHER APPROVED SUPPORT.
9. ALL CONDUIT MUST BE PLACED WITH A MINIMUM 42" OF COVER, UNLESS OTHERWISE SPECIFIED.
10. ALL BACKFILLING WILL BE MECHANICALLY TAMPED IN LIFTS TO A DENSITY OF 90% PROCTOR. THE REQUIRED DENSITY WILL BE OBTAINED BY USING TAMPERS, RAMMERS OR ROLLING EQUIPMENT. LIFTS MAY VARY ACCORDING TO THE TYPE OF EQUIPMENT USED TO OBTAIN THE REQUIRED DENSITY. SAND AND DEBRIS FREE MATERIAL WILL BE USED FOR BACKFILL.

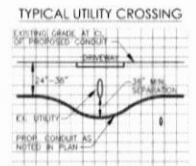
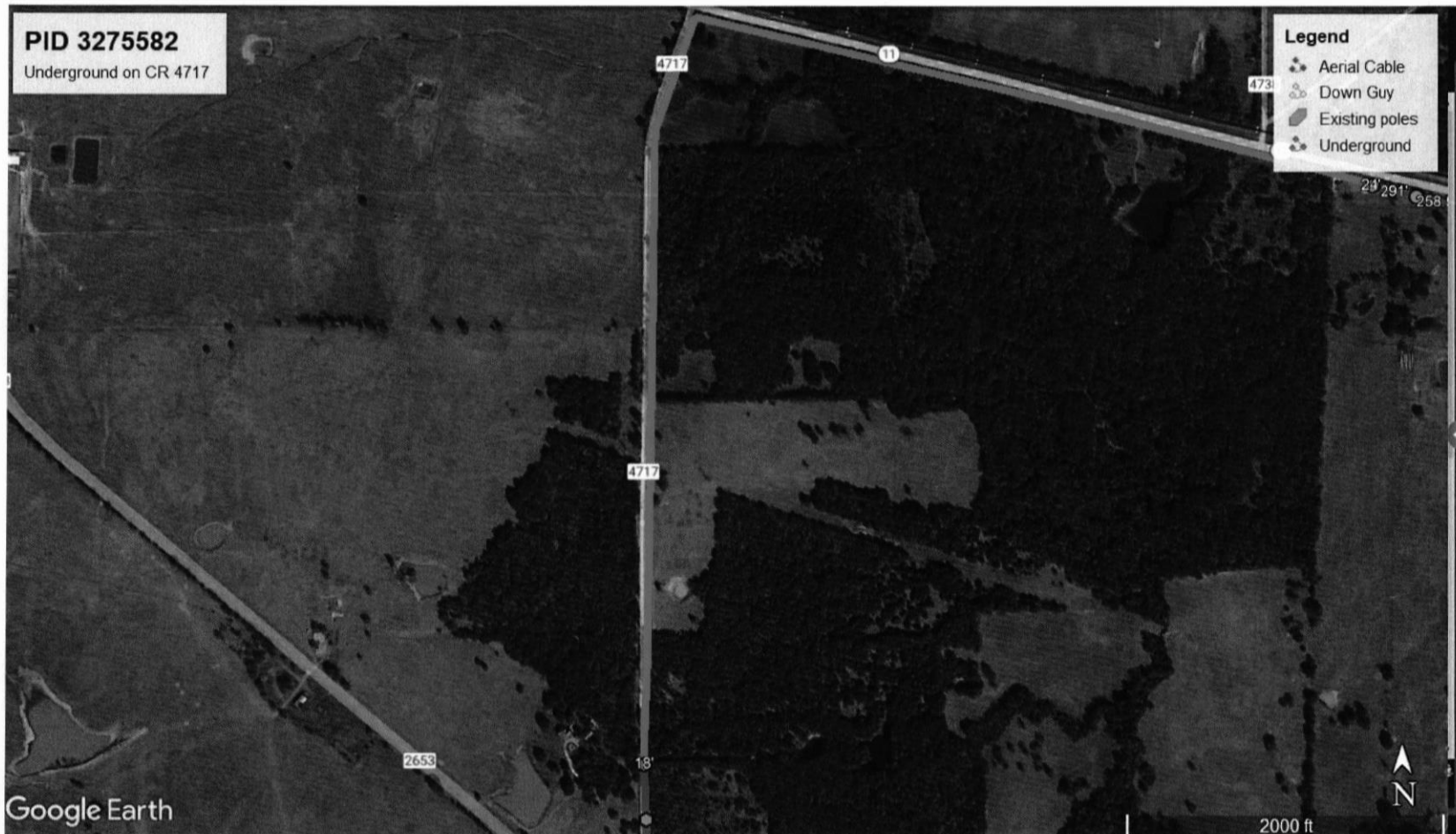

UNDERGROUND CONDUIT 1-2" HDPE

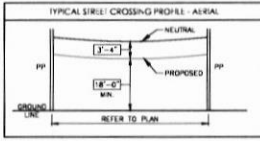

PREPARED BY: DFW TELECOM, INC



1565 Chenault Street, Dallas, Texas 75228

April 7, 2022

Office of Hopkins County Judge
PO BOX 288
Sulphur Springs, Texas 75483

**Underground Parallel &/OR Crossing(s)
Project PID 3540232**

Greetings,

Spectrum/Charter is requesting permission to construct and placement of underground conduit and fiber. This request is for proposed construction county road 4763, which is located in Hopkins County, Texas.

Site location map and google plans are enclosed. The construction plans detail the proposed work.

If you have any questions, please contact me at any time.

Sincerely,

Scott Rone

Project Coordinator
scott.rone@charter.com
Phone 214-629-0606

Submitted by:

Dayna LaPoma / Jessie Hatley
Project Coordinator / RDOF Coordinator
Dayna.lapoma@dfw-telecom.com
Jessie.hatley@dfw-telecom.com

Enclosures

County Approval Section:

Approved: ✓ *OK*

Denied: _____

Authorized Signature: *Jessie*

Date: 4-18-22



NOTE:
CONTRACTOR IS RESPONSIBLE TO MAINTAIN TRAFFIC CONTROL AS SET FORTH IN THE TEXAS MANUAL ON UNIFORM TRAFFIC CONTROL DEVICES FOR STREETS AND HIGHWAYS

Hopkins County Road Power Supply

Project consist of approximately:
approx. 8'-10' coax aerial drop to newly placed meter base pole with meter for power supply.

GENERAL CONSTRUCTION NOTES

1. ALL CONSTRUCTION WORK WITHIN THE PUBLIC RIGHT-OF-WAY SHALL BE DONE IN ACCORDANCE WITH THE ORDINANCES AND REGULATIONS OF THE MUNICIPALITY IN WHICH THE WORK IS TO BE PERFORMED.
2. EXISTING UTILITY LOCATIONS SHOWN ARE TAKEN FROM AVAILABLE RECORDS AND MAY NOT BE ALL INCLUSIVE. UTILITY LOCATIONS ARE GENERALLY SCHEMATIC IN NATURE AND MAY NOT ACCURATELY REFLECT THE SIZE AND LOCATION OF EACH PARTICULAR UTILITY. THE CONSTRUCTION CONTRACTOR SHALL ASSUME RESPONSIBILITY FOR ACTUAL LINE LOCATES IN THE FIELD AND THE PROTECTION OF ALL EXISTING FACILITIES WHETHER SHOWN OR NOT. THE CONSTRUCTION CONTRACTOR SHALL ALSO ASSUME RESPONSIBILITY FOR REPAIRS TO ANY EXISTING FACILITY DAMAGED AS A DIRECT RESULT OF THE CONSTRUCTION ACTIVITIES WHETHER THE FACILITY IS SHOWN ON THE DRAWINGS OR NOT.
3. THE CONSTRUCTION CONTRACTOR SHALL BE RESPONSIBLE FOR CONTACTING ALL DEPARTMENTS WITHIN THE MUNICIPALITY AND THE UTILITY COMPANIES AT LEAST TWO WORKING DAYS PRIOR TO THE COMMENCEMENT OF WORK.
CALL BEFORE YOU DIG
811
IT'S THE LAW
4. IT SHALL BE THE RESPONSIBILITY OF THE CONSTRUCTION CONTRACTOR TO: A) PREVENT DAMAGE TO PRIVATE AND PUBLIC PROPERTY. B) RESTORE ALL AREAS EFFECTED BY THE CONSTRUCTION TO ORIGINAL OR BETTER CONDITION.
5. BARRICADEING AND TRAFFIC CONTROL SHALL BE THE RESPONSIBILITY OF THE CONSTRUCTION CONTRACTOR AND SHALL CONFORM TO THE TEXAS MANUAL ON UNIFORM TRAFFIC CONTROL DEVICES. TRAFFIC FLOW AND ACCESS SHALL BE MAINTAINED DURING ALL PHASES OF CONSTRUCTION. THE CONSTRUCTION CONTRACTOR IS RESPONSIBLE FOR PROVIDING TRAFFIC SAFETY MEASURES FOR WORK ON THE PROJECT. THE WORK SITE SHALL BE SUITABLY LIT AND BARRICADED AT NIGHT.
6. THE CONSTRUCTION CONTRACTOR SHALL ABIDE BY ALL APPLICABLE FEDERAL, STATE AND LOCAL LAWS GOVERNING EXCAVATION. THE CONSTRUCTION CONTRACTOR SHALL PROVIDE ALL TRENCH SAFETY SYSTEMS THAT COMPLY WITH ALL LAWS GOVERNING EXCAVATION. THE CONSTRUCTION CONTRACTOR SHALL BE SOLELY RESPONSIBLE FOR ALL ASPECTS OF WORK RELATED TO EXCAVATION.
7. ALL CONCRETE USED IN ANY ROADWAY SHALL BE IN COMPLIANCE WITH THE SPECIFIED CLASSES OF CONCRETE IN THE STANDARD SPECIFICATIONS 5.8 "PORTLAND CEMENT CONCRETE PAVEMENT" AND 7.4.5 "QUALITY OF CONCRETE" AS AMENDED BY THE ADDENDUM TO THE NORTH CENTRAL TEXAS STANDARD SPECIFICATIONS FOR PUBLIC WORKS CONSTRUCTION - 2004. ALL OTHER CONCRETE SHALL BE CLASS A CONCRETE.
8. ALL REINFORCING STEEL AND DOWEL BARS IN PAVEMENT SHALL BE SUPPORTED AND MAINTAINED AT THE CORRECT CLEARANCES BY THE USE OF BAR CHAIRS OR OTHER APPROVED SUPPORT.
9. ALL CONDUIT MUST BE PLACED WITH A MINIMUM 42" OF COVER, UNLESS OTHERWISE SPECIFIED.
10. ALL BACKFILLING WILL BE MECHANICALLY TAMPED IN LIFTS TO A DENSITY OF 95% PROCTOR. THE REQUIRED DENSITY WILL BE OBTAINED BY USING TAMPERS, RAMMERS OR ROLLING EQUIPMENT. LIFTS MAY VARY ACCORDING TO THE TYPE OF EQUIPMENT USED TO OBTAIN THE REQUIRED DENSITY. SAND AND DEBRIS FREE MATERIAL WILL BE USED FOR BACKFILL.

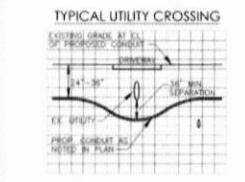
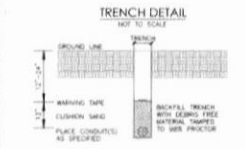

UNDERGROUND CONDUIT 1-2" HDPE

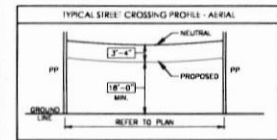

PREPARED BY: DFW TELECOM, INC